

Closed Door Drying Benchtop Autoclave Range

33, 43, 63 litre models

Fitted with heaters in chamber

The Astell Scientific range of 'Closed Door Drying' benchtop steam sterilizers is designed to offer convenience and flexibility in the sterilization of wrapped and unwrapped instruments.

Suitable for use in Dental and Veterinary clinics, these units offer sterilization for instruments and glassware with the added benefit of hot air drying.

This type of autoclave is also sometimes referred to as 'Class S' or 'Type S'.

Items requiring sterilization may include wrapped and unwrapped metal surgical instruments, unwrapped glassware and pouched hand tools.

It is recommended only such accessories as sterilization wraps, pouches, chemical indicators and biological indicators should be used with this autoclave.

The Closed Door Drying benchtop autoclave range is available in three sizes and is totally self-contained. These units require no plumbing, and only a standard single phase power supply.

Ecofill – Every unit in the range features an integral water tank. Once filled, it will supply up to 15 cycles, and also act as a collection vessel for condensate and the water that is automatically returned from the chamber at the end of each cycle (**minimising water usage**).

Other features include:

- Compliant with BS EN 13060:2014; ISO 9001:2015; PED 2014/68/EU; ANSI/AAMI ST55:2010 standard; FDA 510(k) approved; manufactured to the principles of Medical Devices Directive (93/42/EEC)
- Four programmed cycles suitable for solid metal instruments (unwrapped), solid metal instruments (wrapped), glassware (unwrapped), and hand pieces in surgical pouches
- Closed door drying – following sterilization, filtered air is circulated through the chamber by an efficient air pump rapidly drying each load
- Included furniture: chamber shelf rack, two wire shelves and one pouch rack
- 5.7" colour touchscreen with integrated USB data port and data archiving for up to 5,000 previously run cycles
- Create custom cycles – store up to 4 customized cycles in the touchscreen controller (edit, rename and personalise to your requirements)
- PED/ASME standard electropolished stainless steel chamber

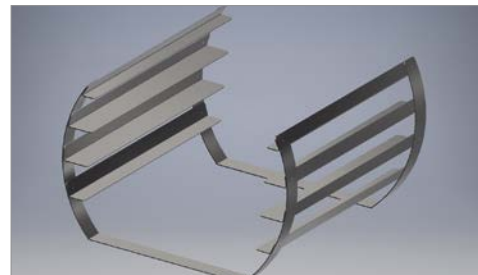

4 position shelf rack



Wire shelf

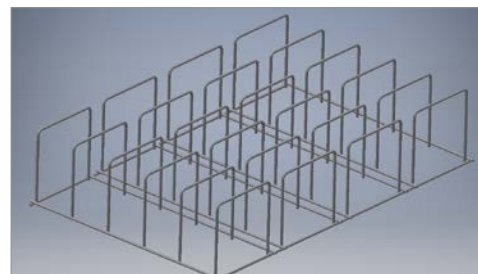

Pouch rack

Specifications

Model no.	Volume (liters)	Power supply	Chamber diam. x depth (mm)	Usable chamber depth (mm)	Overall dimensions W x H x D (mm)	Required bench depth (mm)
UMB220	33	Single Phase, 230V, 13A, 50/60 Hz	350 x 360	294	520 x 600 x 805	670
UMB230	43		350 x 460	403	520 x 600 x 805	670
UMB240	63		350 x 660	600	520 x 600 x 1005	855

(Power consumption/dimensions may vary with the addition of certain options)

Additional options

General	Integral data printer	Ref: AAR130
	FDA 21 CFR part 11 controller software	Ref: CFR021
	Remote maintenance/diagnosis	Ref: RDM101
	Ethernet interface	Ref: AAR122
	IQ/OQ documentation	Ref: IQ/OQ
UMB220	Additional wire shelf	Ref: 389172
	Additional pouch rack	Ref: 389170
UMB230	Additional wire shelf	Ref: 389157
	Additional pouch rack	Ref: 389156
UMB240	Additional wire shelf	Ref: 389171
	Additional pouch rack	Ref: 389169

Chamber capacity

Part name	Part ref.	UMB220	UMB230	UMB240
Wire shelf	See Additional options	4	4	4
Pouch rack	See Additional options	2	2	2

Installation requirements

Power requirements:

The power requirements for the standard machines are listed in the Specifications table.



Touchscreen controller



Ecofill reservoir



Pressure gauge





WolfLabs

Pricing on any accessories shown can be found by keying the part number into the search box on our website.

The specifications listed in this brochure are subject to change by the manufacturer and therefore cannot be guaranteed to be correct. If there are aspects of the specification that must be guaranteed, please provide these to our sales team so that details can be confirmed.

www.wolflabs.co.uk

Tel : 01759 301142

Fax : 01759 301143

sales@wolflabs.co.uk

Please contact us if this literature doesn't answer all your questions.